

Bodypoint® Belt Mounting



STRENGTHEN
YOUR
POSITION®



BELT

Choose a two- or four-point belt or an Evoflex®



END-FITTING

(not applicable to the Evoflex®)



HARDWARE

Add mounting hardware, if needed, to fit the wheelchair.



Every product combination is tested to ISO, ANSI/RESNA and EN standards.

STEP 1

SELECT A BELT www.bodypoint.com/paddedhipbelts

STEP 2

CHOOSE AN END-FITTING (Ø6mm mounting holes)

Flat-Mount™ (-B1)



Features
Low profile for tight spaces. Fits in 5mm (3/16") gap.

Material
Heat-treated, satin-finish, nickel-plated steel

Typical Breaking Strength
283kg (624 lbs)

Cinch-Mount™ (-B2)



Features
Easy to adjust for clothing and weight changes. Fits in 16mm (5/8") gap.

Material
Satin-finish, chrome-plated steel, nickel-plated pins, Delrin® cover

Typical Breaking Strength
453kg (1000 lbs)

STEP 3

ADD MOUNTING HARDWARE, if needed

FrameSaver® Clamp

HW303

Frame Type: **A**

Fits Frame Sizes:
Ø22mm (7/8") & 25mm (1") tubes; Ø19mm (3/4") shim available separately (HW303-19SHIM)

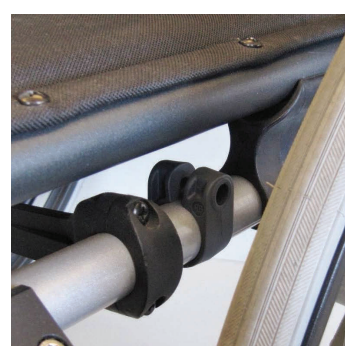

On a 25mm (1") tube

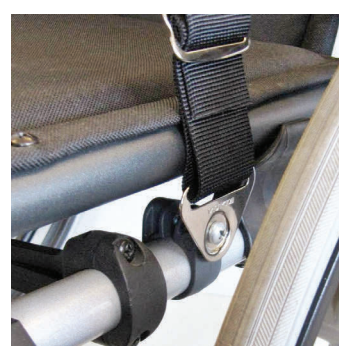

With a Flat-Mount™

Frame Clamp

HW310

Frame Types: **A, C**

Fits Frame Sizes:
Ø22 (7/8") & 25mm (1") tubes

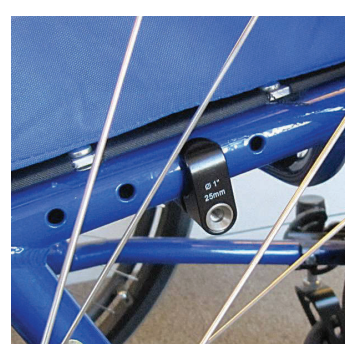

Under upholstery



On a shower chair

Band Clamp

HW320

Frame Types: **A, B, C**

Fits Frame Sizes:
Ø22mm (7/8"), 25mm (1"), 27 x 33mm (1-1/16" x 1-5/16"), 29mm (1-1/8"), 30mm (1-3/16"), 32mm (1-1/4") tubes



Under upholstery

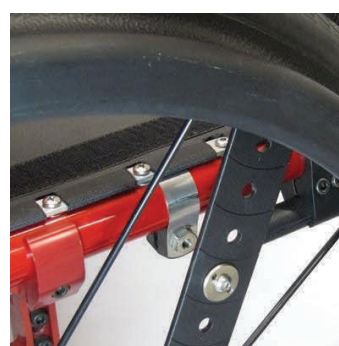

With an Evoflex®

Seat Tube Mounting Bracket Kit

HW200-20

20° bracket

HW200-90

90° bracket

Frame Type: **C**
or mount directly to a solid surface



20° brackets for side mounting



90° brackets for top mounting



Mounting an Evoflex® over upholstery

T-Slot Fastener Kit

HKA6

6mm (1/4")

Frame Type: **D**

HKA10

10mm (3/8")

Frame Type: **E**

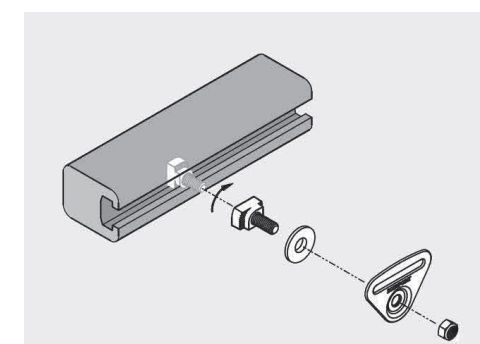

With a Flat-Mount™

Belt Mounting Extension Kit

HKA12

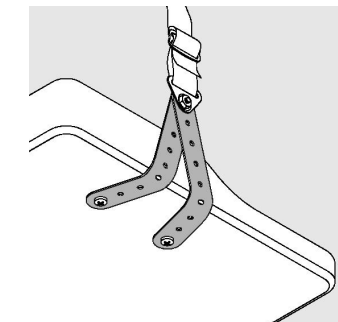

Bend under seat for direct attachment

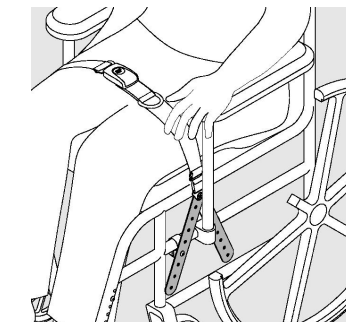

Spread apart to span obstructions

Hardware Gauge

BMR-42

Quickly determine frame type and size



Measure size of round frame



Measure T-slot width

FRAME TYPES

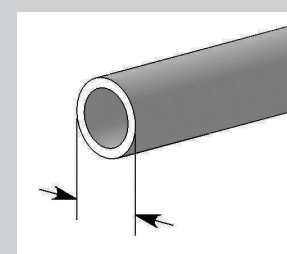

(A) Round
Ø19, 22, 25, 29, 30, 32mm

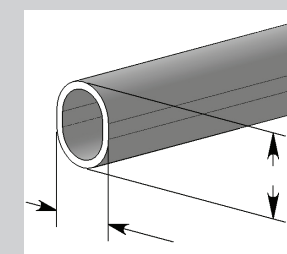

(B) Oval
Quickie Wheelchairs 27mm x 33mm

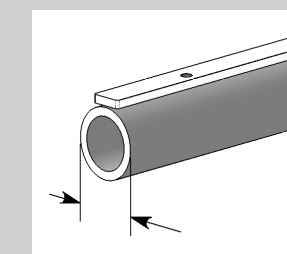

(C) Tube
with threaded holes for upholstery strip

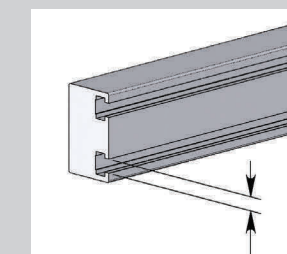

(D) Permobil/Unitrack
6mm T-slots

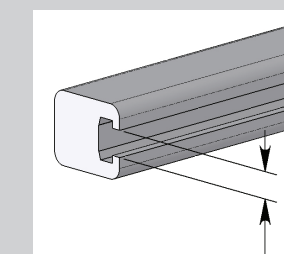

(E) Invacare/Pride/Quantum
10mm T-slots

Instructions, specs and help: sales@bodypoint.com, 800.547.5716, www.bodypoint.com
Technical videos: tiny.cc/bpvideos