

**Specifications**

Material: Anodized Aluminum, Nickel Plated Steel  
Screw Threads: M6  
Tools Required: 4mm (5/32") Hex Key  
Max. Load: 2000N / 450 lb

Available in models which fit both metric and fractional tube sizes:

HW310-22-A Ø22mm (7/8-inch)

HW310-25-A Ø25mm (1-inch)

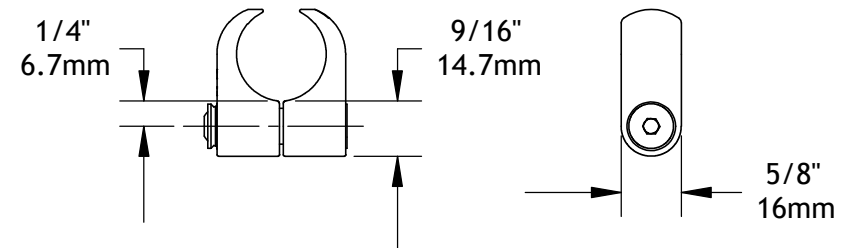

**FRAME CLAMPS--The Universal Attachment Solution**  
Seat Hardware Attachment, Difficult Belt Mounting, Custom Adaptations on Straight or Curved Tubing--  
Any Application Where Mounting Presents a Challenge!

- \* High strength aluminum and steel construction
- \* Innovative fastener permits adjustments to attached hardware without loosening clamp
- \* Low-profile, partial wrap design allows installation close to joints, armrests, and upholstery
- \* Superb black anodized finish complements all types of wheelchair frame
- \* Includes flat head and button head hardware mounting screws

description				<b>FRAME CLAMPS</b>
drawing no.	date originated	drawn by	rev.	
<b>D06-1107-01</b>	11/7/2006	M. KOSH	<b>B</b>	